

Let. nr 1 do 072

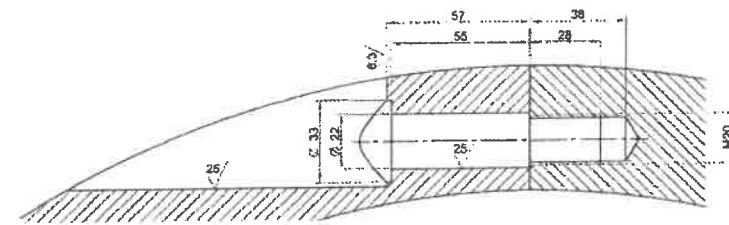

Section A-A  
1:1

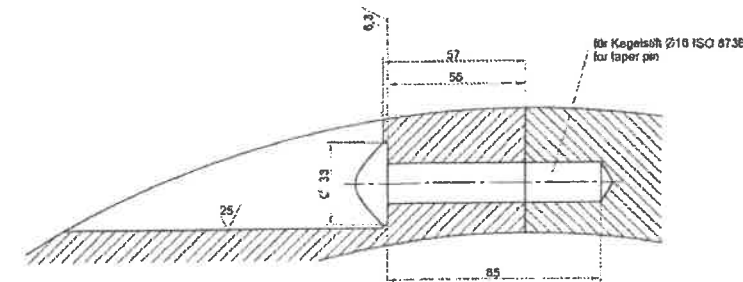

Section B-B  
1:1

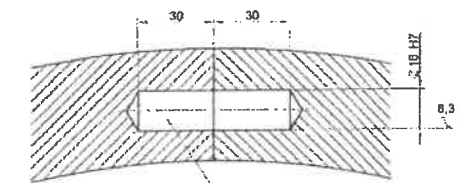

Section C-C  
1:1

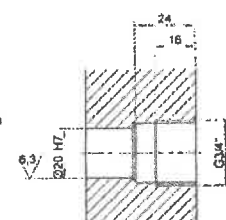
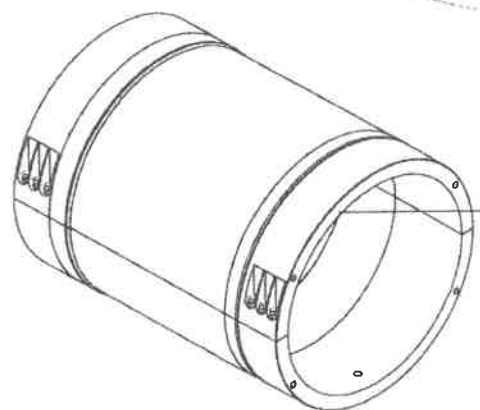
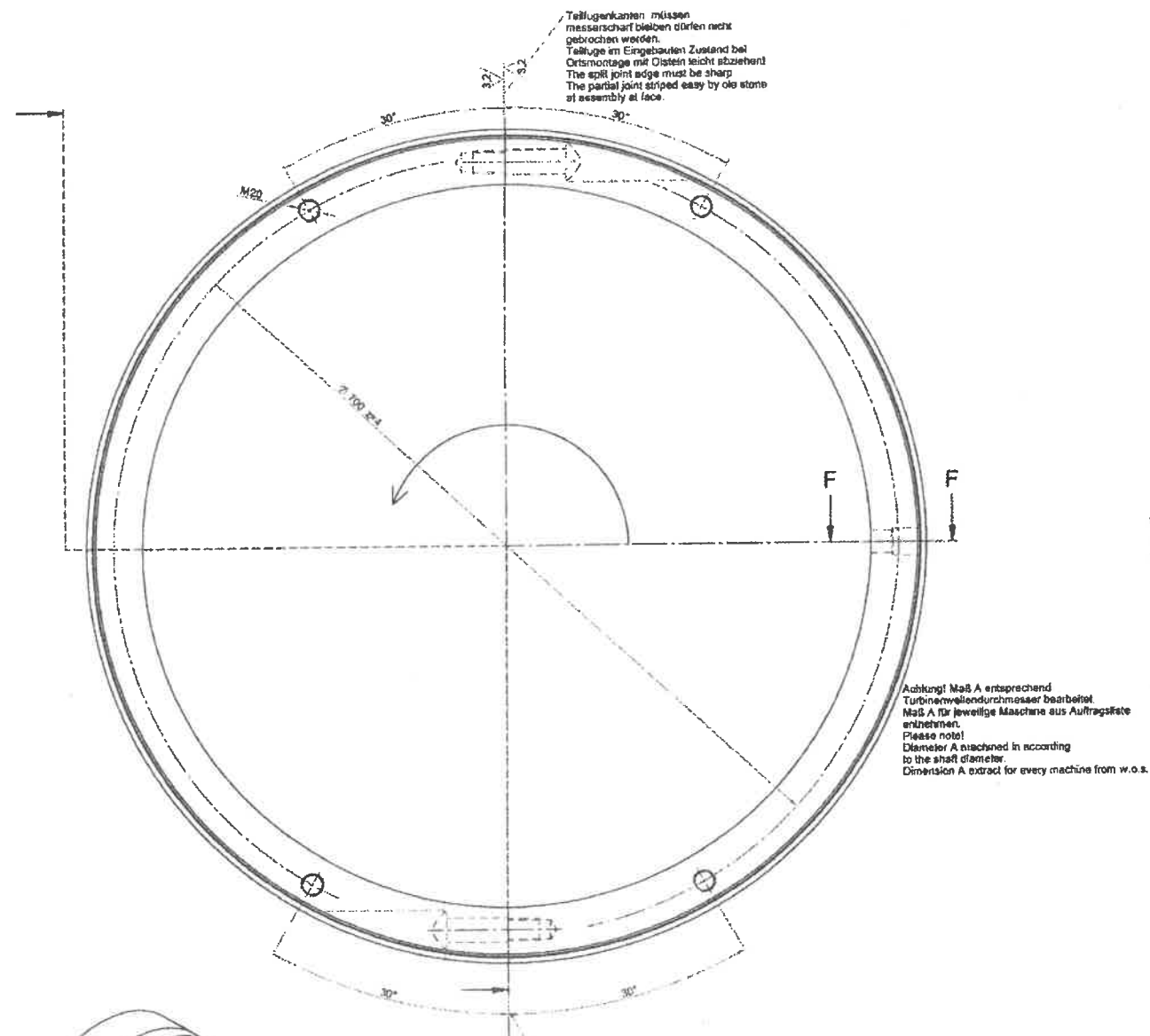

Section F-F  
1:1

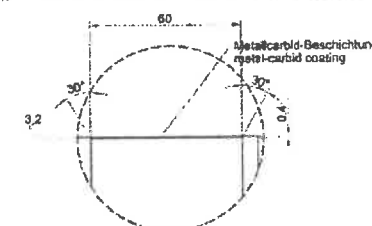
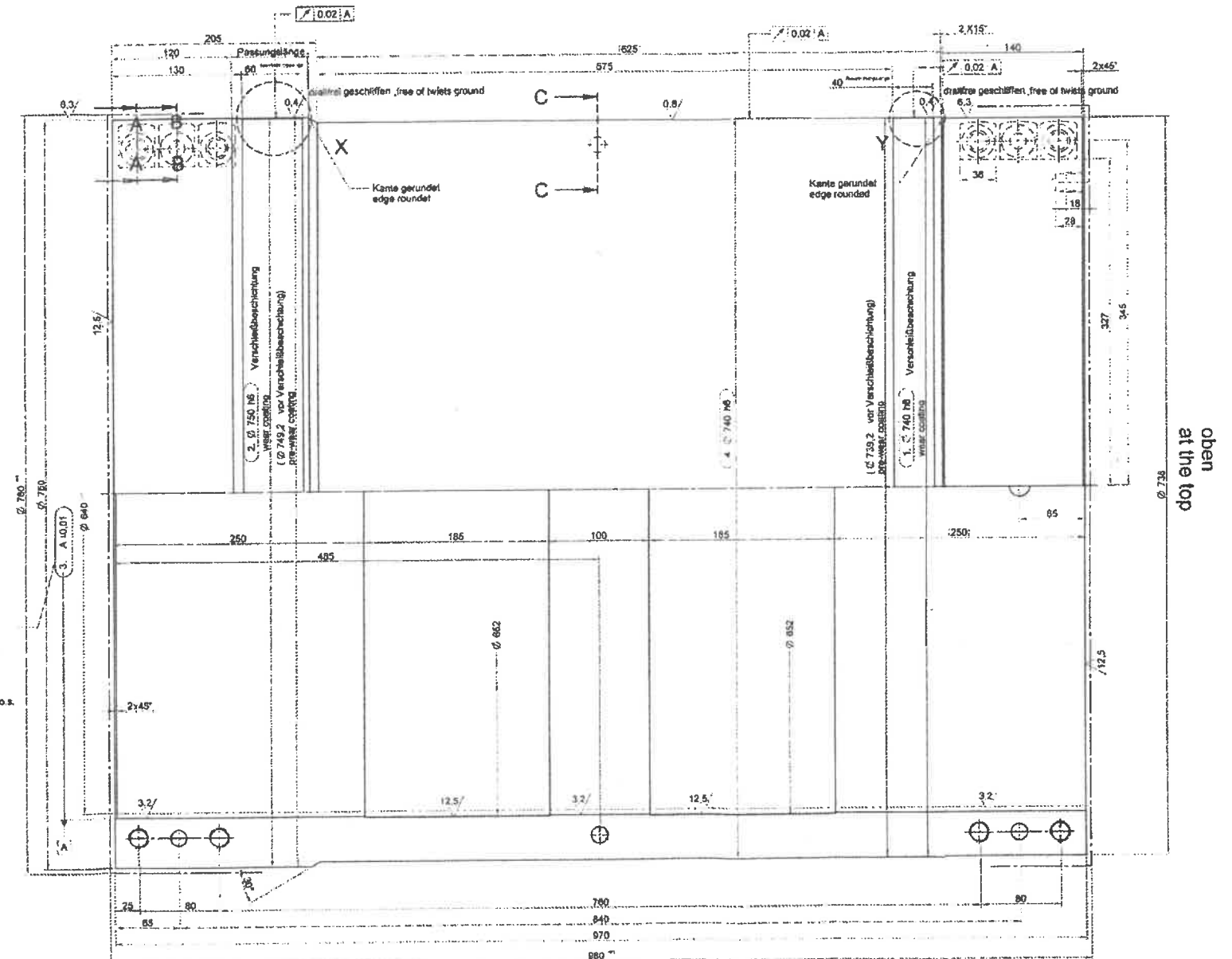

detail  
1:1

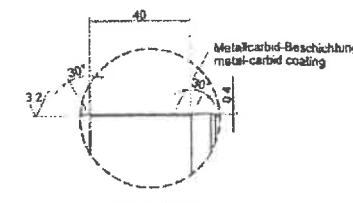

detail Y  
1:1

Harta HB 245-310  
steeliness

Weltenschonhulze nicht in Einbaulage  
gezeichnet  
shaft protective sleeve not signed  
in installation position

The photograph shows a document with a grid on the left and a form on the right. The grid contains handwritten text: '750 H6', '740 H6', '20 H7', and '18.47'. The form contains the following text:

**Dychow**

Handwritten: 12, 1.4315, 780

Printed: Welienschonnhülse 2lg

Printed: shot cartridge sleeve 2 p